

MOBILE THERMAL PRINTER

User Manual

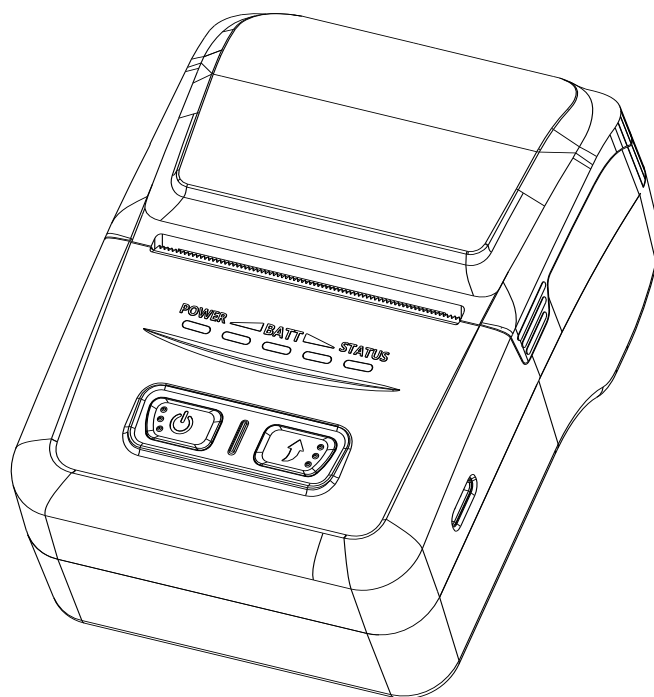

CONTENTS

PRECAUTIONS	3
CHAPTER 1 BRIEF INTRODUCTION	4
1.1 APPEARANCE	5
1.2 ACCESSORIES	5
CHAPTER 2 SPECIFICATIONS	6
CHAPTER 3 OPERATION METHODS	7
3.1 PREPARATION BEFORE USING	7
3.1.1 <i>Li-ion Battery Installation</i>	7
3.1.2 <i>Paper Loading</i>	7
3.2 BASIC FUNCTIONS.....	8
3.2.1 <i>Power On</i>	8
3.2.2 <i>Power Off</i>	8
3.2.3 <i>Self-Test</i>	8
3.2.4 <i>Paper Feeding (Manual Paper Feeding)</i>	8
3.2.5 <i>Battery Charging</i>	8
3.3 PRINTER CONNECTING AND PRINTING.....	9
3.3.1 <i>Bluetooth Pairing and Printing</i>	9
3.4 LED INDICATOR AND BUZZER DEFINITION.....	9

PRECAUTIONS

1. Safety Precautions

- 1) Be sure to use the specified battery and power supply provided by our company.
- 2) Connection to an improper power supply may cause burning, explosion or damage to printer.
- 3) Don't put the battery into fire or water, don't disassemble or modify the battery, don't be short circuit, otherwise may result in injury or even fire explosion.
- 4) If the printer would not be used for a long time, be sure to take off the battery, otherwise the battery may leak liquid which is corrosive. If improper operation causes battery leak, and the liquid is spattered on the skin or clothes, please wash it with water. if spattered into eyes, please rinse them with water thoroughly and soon see a doctor.
- 5) Please do not open the paper case cover while it is printing or just when printing is over, do not touch the print head with hand or body, overheat may cause scald.

2. Operation Precautions

- 1) Water or other liquid should not spill into the printer, also the printer should not be exposed in rain or else may cause printer damage.
- 2) Please do not open the paper case cover when it is printing, otherwise the printer may work improperly.
- 3) When printing with Bluetooth interface, the communication distance should be within 10 meters, otherwise the printer doesn't print or it will print rubbish codes.
- 4) Too high (50°C) or too low (-5°C) temperature and too high (80%) or too low (25%) relative humidity both will affect the printing quality.
- 5) The thermal paper in poor quality or stored for too long time also may reduce the printing quality or even damage the printer.

3. Storage Precautions

- 1) The printer should be placed in such an environment that the temperature is between -20°C to 70°C, and the relative humidity is within 5% to 95%.
- 2) If the printer will be stored for a long time, please be sure to take out the battery, otherwise may damage the battery and printer.
- 3) Normal thermal paper can't be kept too long, if you need to keep the receipt for a long period, please choose long term effective thermal paper.
- 4) The thermal paper should be keep away from high temperature environment and point-blank sunshine.

4. Battery Safety Precautions

- 1) Be sure to carefully read the user manual before using this product.
- 2) Ignore the following instructions may cause battery overheating, burning, explosion, damages the performance and reduce the product life.
 - ① Do not allow water, sea water from entering or leaking into the battery inside. If the battery internal safety device burn, when charging it, it may produce abnormal current, voltage, and chemical reaction to cause the battery overheating, burning and explosion.
 - ② Do not use or place the battery nearby the stove or other high temperature places. Excessive heat may damage the resin shell or the insulation materials, thereby cause short-circuit inside the battery and result the battery overheating, burning and explosion.
 - ③ When charging, use a specified charger. Other conditions (high temperature, high pressure/high current, using the modified battery charger, etc.) excluded here may result in over-charging the battery and abnormal current or voltage, cause abnormal chemical reaction, and may cause the battery overheating, burning or explosion.
 - ④ Do not make the battery contact with the power outlet or car cigarette lighter socket. This may cause high pressure and excessive current, and lead the battery overheating, burning or explosion.
 - ⑤ Do not heat the battery or put the battery into fire. This may melt insulation material and damage safety devices or safety equipment, then ignite electrolytic solution, and cause the battery overheating, burning or explosion.
 - ⑥ Do not use the battery with contrary (+) and (-) location. In the charging process, this will cause the reverse charging and may cause abnormal chemical reaction. During use, may appear unpredictable current exception, and cause the battery overheating, burning or explosion.
 - ⑦ Battery clearly marks with positive and negative. When connect the battery with the charger or printer, be sure to verify the correct battery orientation. Reverse insertion will cause the reverse charging and may cause abnormal chemical reaction, and then may cause the battery overheating, burning or explosion.
 - ⑧ Do not make the battery (+) and (-) connect with any metal. Also, do not carry along or store batteries with metal objects, such as necklaces, hair clips and so on. Battery internal short circuit may cause excessive current, and lead to the battery overheating, burning or explosion and the adjacent metal objects (necklaces, hairpins, etc.) may be overheated.
 - ⑨ Do not throw or heavily attack the battery. If internal safety device of the batteries burned, the battery charging may cause abnormal current and voltage, and abnormal chemical reaction, and lead the battery overheating, burning or explosion

CHAPTER 1 BRIEF INTRODUCTION

1.1 Appearance

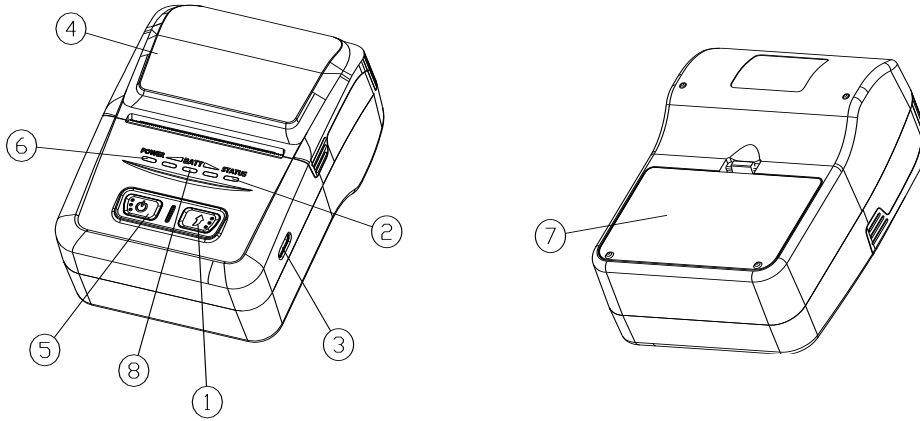

- 1. Feed button
- 2. Status indicator (Green LED+ Red LED)
- 3. USB interface
- 4. Printer top cover
- 5. Power button
- 6. Power indicator (Green LED+ Blue LED)
- 7. Li-ion battery
- 8. Battery indicator

1.2 Accessories

Standard Accessories

Li-ion Battery

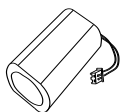

Power Plug [5V/1A]

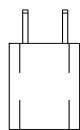

USB cable(type C)

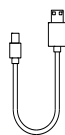

Paper Roller

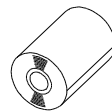

User Manual

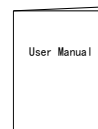

Optional Accessories

Leather Case



CHAPTER 2 SPECIFICATIONS

ITEM		Parameter
Printing	Printing method	Thermal dot line printing
	Resolution	203dpi, 8dots/mm
	Printing speed	50~80mm/s
	Valid printing width	48mm
	Interface	Bluetooth and USB
Power saving	Sleep mode	YES
Character Set	Font	ASCII:9x17,12x24; Multiple code pages support
Barcode Symbologies	1D	UPC-A, UPC-E, EAN8, EAN13, CODE39, ITF, CODEBAR, CODE128, CODE93
	2D	QR code
Graphics		Support bitmap printing with different density and user defined bitmap printing (Max. 40K for per bitmap, and Max. 64K for total)
Detection	Sensors	Paper out detection
LED indicator	Power	Power green
		Power blue
	Status	Status green
		Status red
Charging	Charger	5V/1A in adapter
	Battery	2000mAh/7.4V rechargeable Li-ion battery Full charge can print 100~200m (printing density not more than 12.5%) or 80~100mm (printing density not more than 25%)
	Recommended paper	FD210, PD150R, PD160R
	Paper width	58mm
	Paper thickness	60~80μm
	Paper roller diameter	≤40mm
	Paper loadi	Easy loading mechanism
Physical characteristics	Working condition	-10°C~50°C , 20%~85%RH
	Storage condition	-20°C~70°C, 5%~95%RH
	Dimension	107.0*81.0*49.0mm
	Weight	250g (without paper roll)
Reliability	TPH	50km (not more than 12.5% printing density)/100 million pulses
Software	Emulation	ESC/POS compatible command set
	Driver	Windows XP//Win7/Win8/Win10

CHAPTER 3 OPERATION METHODS

3.1 Preparation Before Using

3.1.1 Li-ion Battery Installation

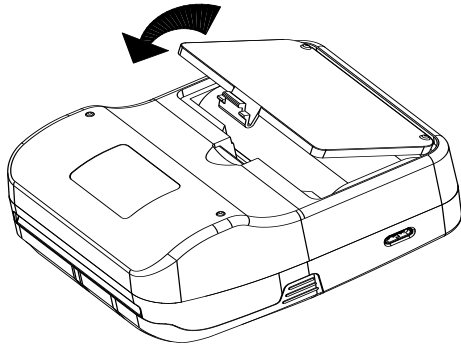

- 1) Refer to the above picture, put the battery in the battery slot (pay attention to the correct positive and negative).
- 2) Close the battery case.

3.1.2 Paper Loading

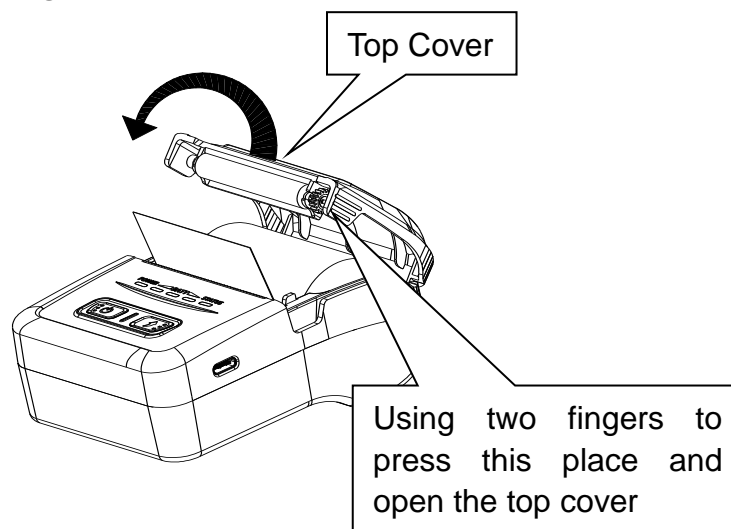

- 1) Put into paper roller (pay attention to the paper direction, If loaded reversely, it won't print) and close the top cover (Pull paper little out of paper case).

3.2 Basic Functions

3.2.1 Power On

The printer is power on by pressing the **【POWER】** button lasting for about 2 seconds, and the power indicator is bright in green color.

3.2.2 Power Off

The printer is power off after holding down the **【POWER】** button for about 2 seconds when the printer is on. All the indicators are off when the printer is off

3.2.3 Self-test

The self-test indicates the printer's current settings, status and whether the printer has any problem. Hold down the **【FEED】** button while press **【POWER】** button about 2 seconds, the self-test begins. The printer is ready to receive data as soon as it completed self-test.

3.2.4 Paper Feeding (Manual paper feeding)

Users could use **【FEED】** button to feed paper manually when printer on normal working status.

3.2.5 Battery Charging

Before the battery runs out of power, the printer will alarm to remind you to charge it

Charging Method:

- ① Connect the power charger to the power connector of the printer.
- ② Plug the power charger into an electrical outlet (Printer could be in use when charging).

Power-off/Power-on charging: LED status light will always indicate green color and goes off when fully charged.

NOTE: Please use the original battery and power charger, otherwise printer may be damaged or even cause explosion.

3.3 Printer connecting and Printing

3.3.1 Bluetooth pairing and printing

PDA with Bluetooth interface, laptop and other information terminals can drive the mobile thermal printer MP58C6. Instructions as follows:

1. Power on printer.
2. Primary device search for outer Bluetooth devices.
3. If there are some outer Bluetooth devices, choose MP58C6.
4. Enter password "0000".
5. Finish matching.

Note: when pairing, mobile thermal printer MP58C6 must be on. Do not set many printers on when pairing, otherwise it can't figure out which printer is the one that succeed in pairing.

Usually, one printer pair with one host machine, it is possible that one printer pair with more host machines too.

3.4 LED Indicator and Buzzer Definition

There are one buzzer and four LED indicators to indicate the printer status. LED indicators indicate current status and buzzer indicates the changes of printer status. The four LED indicators are MODE_GREEN, MODE_BLUE, STATUS_GREEN, STATUS_RED.

- 1) MODE_GREEN (FIRST ONE): Power on indicator, lighting after printer power on,
- 2) MODE_BLUE (FIRST ONE): Bluetooth indicator, lighting after BT connected, and the green mode will be off.
- 3) STATUS_GREEN (LAST ONE): Charging status, the last indicator will be lighting when the printer be charged,
- 4) STATUS_RED (LAST ONE): Error status, when the printer out of paper, the last one indicator will be lighting.
- 5) BATTERY_WHITE (Second, Third and Fifth): The middle three indicators are the battery indicators. When the 3 indicators all light in white the printer with 99% power, When there 2 indicators light the printer with 66% power, when there is only 1 indicator light the printer with most 33% power.

Printer State	BT State	BT LED (Blue)	Power LED/ (Green)	ERROR LED (Red)	CHARGE LED (Green)	Buzzer	Note
Power On			ON			Once	
Standby	OFF		ON				
	ON	ON					
Charging	OFF		ON		ON		Green light off when full charged
	ON	ON				Once	
Paper Out	OFF		ON	ON		3 Times	
	ON	ON					
Low Voltage	OFF		ON			ON	When start to charging, buzzer off
	ON	ON					
High Temperature	OFF		ON	Blink			
	ON	ON					
Power Off					ON [when charging]		Green light off when full charged
Note:							

Note:

- 1) **【Power LED】** : when turn on the printer, the **Power LED** will be on.
- 2) **【BT LED】** : when the printer is connected by smart phone or other master device which is with Bluetooth, **BT LED** will be on.
- 3) **【ERROR LED】** : Once error was found in the printer, the **ERROR LED** will be on (such as if printer out of paper).
- 4) **【CHARGE LED】** : when printer is in charging, the **CHARGE LED** green will be on.